

NOTE:
 1) PIPE LINE R/W GRANT TO ENTERPRISE ENERGY CORPORATION IN DEED VOLUME 744, PAGE 22. EASEMENT IS NOT PLOTTABLE DUE TO VAGUENESS OF LOCATION OF LINE.
 2) PIPE LINE R/W GRANT TO CNG DEV. Co. OF PITTSBURGH, PA IN DEED VOLUME 747, PAGE 755. EASEMENT IS NOT PLOTTABLE DUE TO VAGUENESS OF LOCATION OF LINE.

SURVEY PLAT & LEGAL DESCRIPTION
 APPROVED PER R.C. 315.251
 R.S. 8/31/2000
 OFFICE OF THE SURVEYOR
 GEauga COUNTY ENGINEER

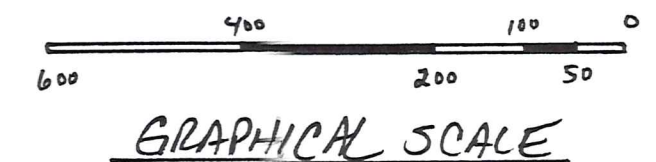

I HEREBY CERTIFY:

This map was prepared and the premises surveyed in accordance with chapter 4733-37 of the Ohio Administrative Code.

Henry Jones #6343

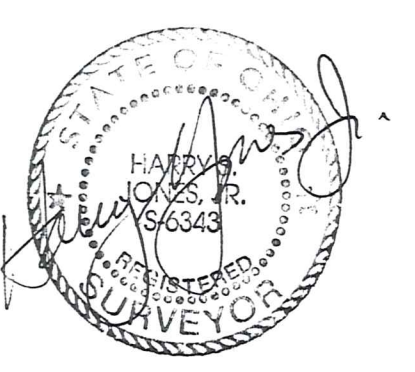

REV. NO.	DESCRIPTION	DATE	BY	CHK'D
1	REVISED PER GEALIGA COUNTY PLANNING COMM	3-17-99	HJ	HJ
2		3-23-99	HJ	HJ
3	ADDED LOT SPLIT "B"	6-9-99	HJ	HJ
4	REVISED PLAT		HJ	HJ
5	ADDED LOT SPLIT "C"	4-13-99	HJ	HJ
6	REVISED PLAT	4-27-99	HJ	HJ
7	REVISED PLAT	8-12-99	HJ	HJ
8	REVISED PLAT	9-1-99	HJ	HJ

- 9. ADDED DITCHES & GAS WELL 12-22-99
- 10. ADDED LOT SPLIT "I" 3-7-00
- 11. ADDED LOT SPLIT "J" 8-2-00
- 12. REVISED PLAT 8/25/00

bj BABCOCK, JONES AND ASSOCIATES, INC
 CIVIL ENGINEERS - SURVEYORS - LAND PLANNERS
 PAINESVILLE OHIO 44077

DATE 11/25/97
 DESIGN BY H.J.
 DRAWN BY T.R.
 APPROVED BY H.J.

LOT SPLIT FOR JEFF OROSZ PART OF LOT No. 8 & 9 THOMPSON TOWNSHIP GEALIGA COUNTY STATE OF OHIO

SCALE 1"=200'
 JOB NO 97-261
 SHEET 1 OF 1

THO-00159

THO 00159

OROSZ "J"
Picked up 8/31/00



BABCOCK - JONES & ASSOCIATES, INC. 30-095098
CIVIL ENGINEERS AND SURVEYORS

1924 MENTOR AVE., PAINESVILLE, OHIO 44077 PHONE (216) 357-1811 FACSIMILE (216) 357-9173

August 28, 2000

REVISED LEGAL DESCRIPTION OF LOT SPLIT "J" FOR JEFF OROSZ.

Situated in the Township of Thompson, County of Geauga and State of Ohio and known as being a part of Lot No. 8 in said Township and being part of land conveyed to Herbert Jones by deed recorded in Volume 1023, Page 190 of Geauga County Deed Records and being further bounded and described as follows;

Beginning at the intersection of the centerlines of Clay Street (60 feet wide) and Thompson Road (50 feet wide);

Thence North 3°04'08" East along the centerline of Clay Street a distance of 559.15 feet to the principal place of beginning;

COURSE I: Thence North 3°04'08" East along the centerline of Clay Street a distance of 300.00 feet to a point at the southwesterly corner of land conveyed to Herbert Jones as recorded in Volume 1286, Page 1161 of Geauga County Plat Records;

COURSE II: Thence South 86°55'52" East along the southerly line and to the southeasterly corner of Herbert Jones, passing thru an 5/8" iron pin set at 30.00 feet a distance of 749.18 feet to a 5/8" iron pin set on the westerly line of land conveyed to Cornelius and Marian Benyak, Trustee by deed recorded in Volume 961, Page 1001 of Geauga County Deed Records;

COURSE III: Thence South 0°33'31" East along the westerly line of Cornelius and Marian Benyak, Trustee a distance of 163.05 feet to a 5/8" iron pin set;

COURSE IV: Thence South 71°53'29" West a distance of 380.00 feet to a 5/8" iron pin set;

COURSE IV: Thence North 86°55'52" West, passing thru a 5/8" iron pin set at 375.16 feet, a distance of 405.16 feet to the principal place of beginning and containing 4.653 acres of land as surveyed and described by Harry S. Jones, Registered Surveyor No. 6343 in August, 2000.

Bearings are based upon the centerline of Clay Street being North 3°04'08" East and are used to describe angles only.

Deed of record 1023-190.

SURVEY PLAT & LEGAL DESCRIPTION
APPROVED PER R.C. 315.251

R.S. 8/30/2000
OFFICE OF THE *Revised*
GEAUGA COUNTY ENGINEER